



ENOX E

ASSA ABLOY

Spider Fitting System



CONTENT

ESPIDER 027	01
ESPIDER 021	01
ESPIDER 028	02
ESPIDER 022	02
ESPIDER 023	03
ESPIDER 024	03
ESPIDER 025	04
ESPIDER 033	04
ESPIDER 030	05
ESPIDER 031	05
EROUTEL 005	06
EROUTEL 006	06
ESFP	07
ESSP	07

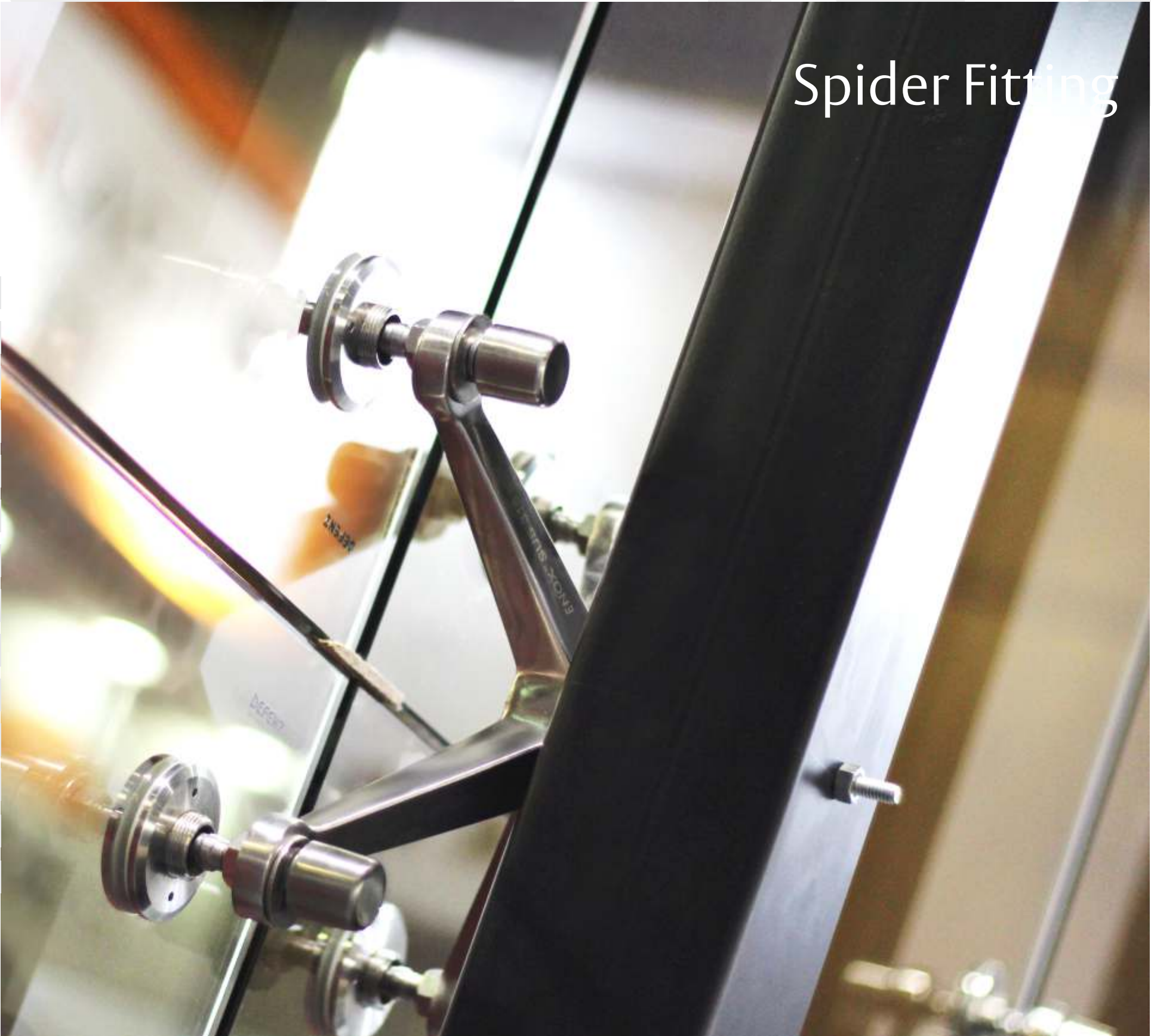

Spider Fitting

ESPIDER 027
Four Way Spider Fitting for
glass facade with fin support
Features :
• Material : Stainless steel 316 grade

Article No.	Finish
ESPIDER 027	Satin/ Glossy

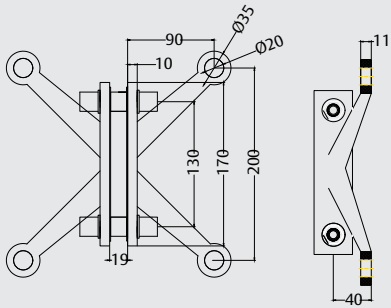

Glass cut-out details

ESPIDER 021
Four Way Spider Fitting for glass facade / canopy
suitable for truss based application
Features :
• Material : Stainless steel 316 grade

Article No.	Finish
ESPIDER 021	Satin/ Glossy

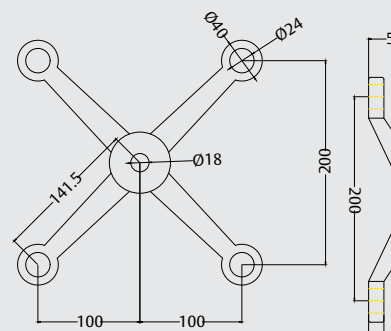

Glass cut-out details

ESPIDER 028
Two way glass to glass 180°
spider fitting with fin support
Features :
• Material : Stainless steel 316 grade

Article No.	Finish
ESPIDER 028	Satin/ Glossy

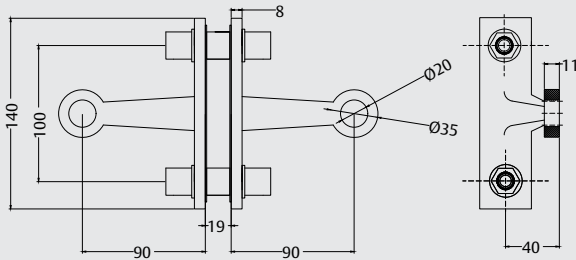

Glass cut-out details

ESPIDER 022
Three way spider fitting for glass facade / canopy
suitable for truss based application
Features :
• Material : Stainless steel 316 grade

Article No.	Finish
ESPIDER 022	Satin/ Glossy

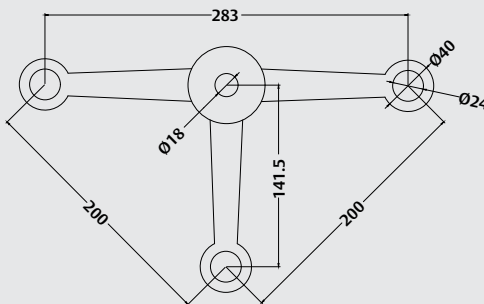

Glass cut-out details

ESPIDER 023
Two way 90° spider fitting for glass facade /
canopy suitable for truss based application

- Features :
- Material : Stainless steel 316 grade

Article No.	Finish
ESPIDER 023	Satin/ Glossy

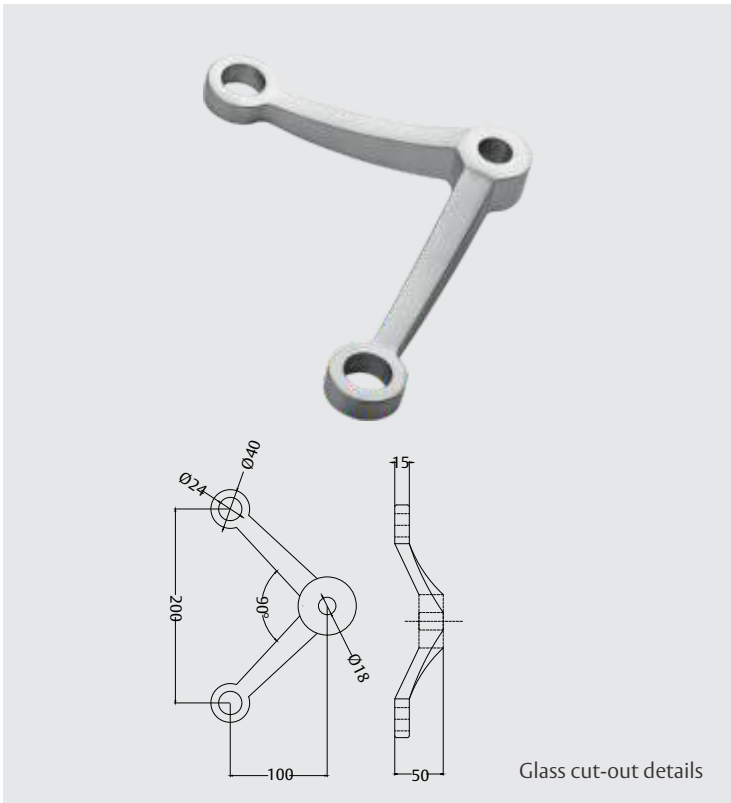

ESPIDER 024
Two way 180° spider fitting for glass facade /
canopy suitable for truss based application

- Features :
- Material : Stainless steel 316 grade

Article No.	Finish
ESPIDER 024	Satin/ Glossy

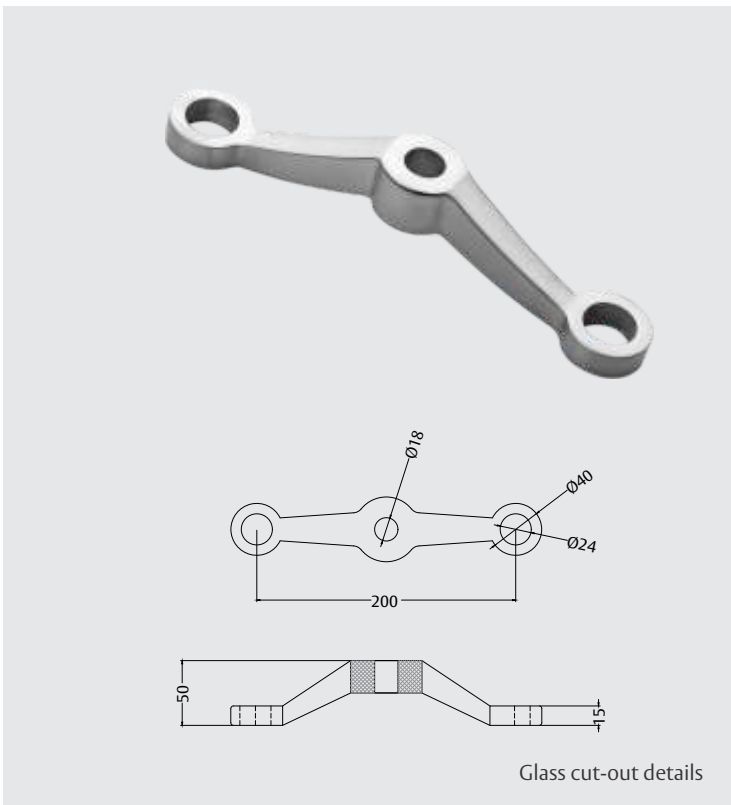

ESPIDER 025
One way spider fitting for glass facade / canopy
suitable for truss based application

- Features :
- Material : Stainless steel 316 grade

Article No.	Finish
ESPIDER 025	Satin/ Glossy

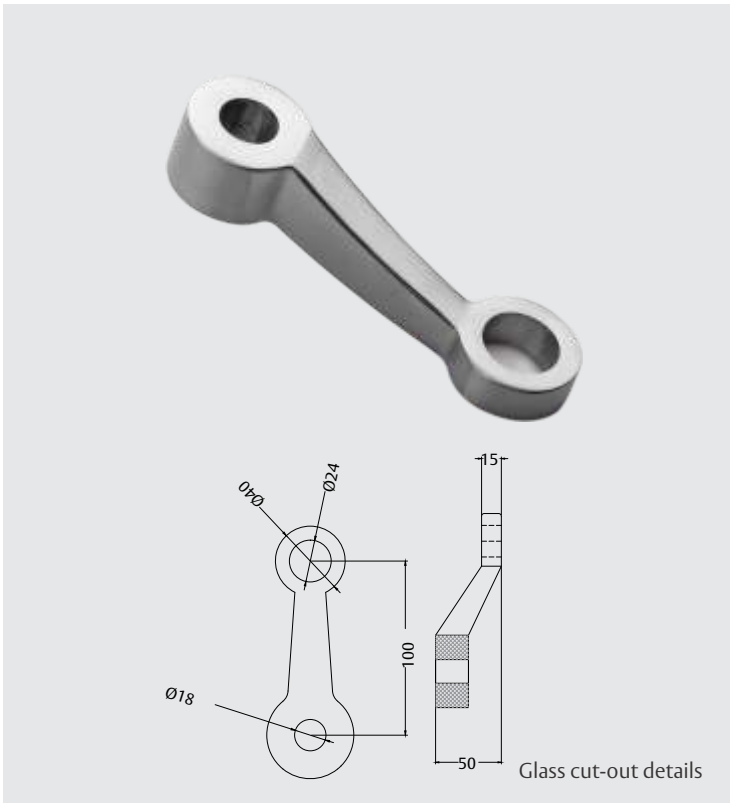

ESPIDER 033
Two way 90° spider fitting for glass facade
with 90° support

- Features :
- Material : Stainless steel 316 grade

Article No.	Finish
ESPIDER 033	Satin/ Glossy

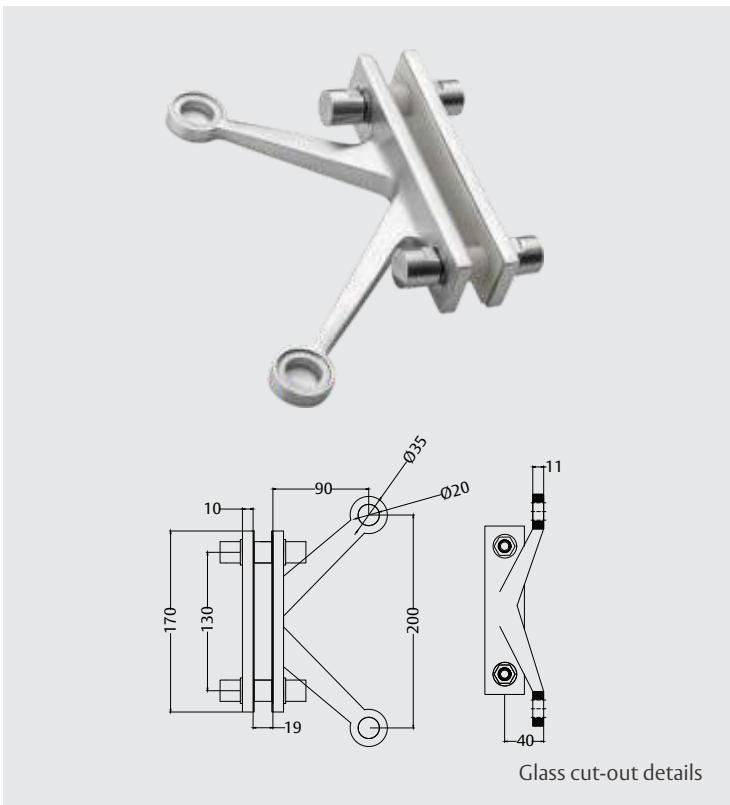

Glass Spider Fitting

Spider Systems

ESPIDER 030

Two way 90° spider fitting wall mounting

- Features :
- Material : Stainless steel 316 grade

Article No.	Finish
ESPIDER 030	Satin/ Glossy

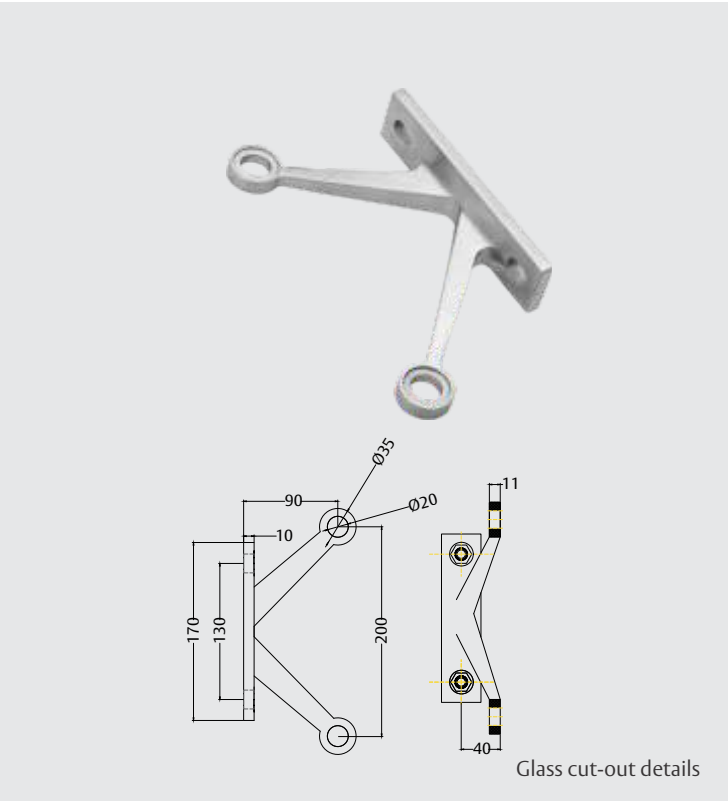

ESPIDER 031

One way spider fitting ceiling / wall mounting

- Features :
- Material : Stainless steel 316 grade

Article No.	Finish
ESPIDER 031	Satin/ Glossy

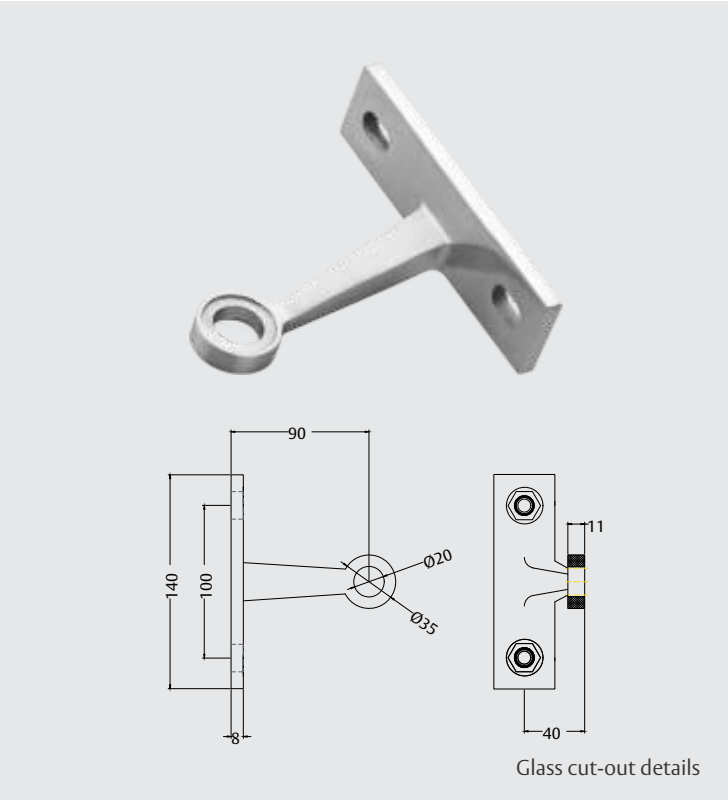

Glass Spider Fitting

Spider Systems

EROUTEL 005

SS Articulated routel flat head

- Features :
- Material : Stainless steel 316 grade

Article No.	Finish
EROUTEL 005	Satin/ Glossy

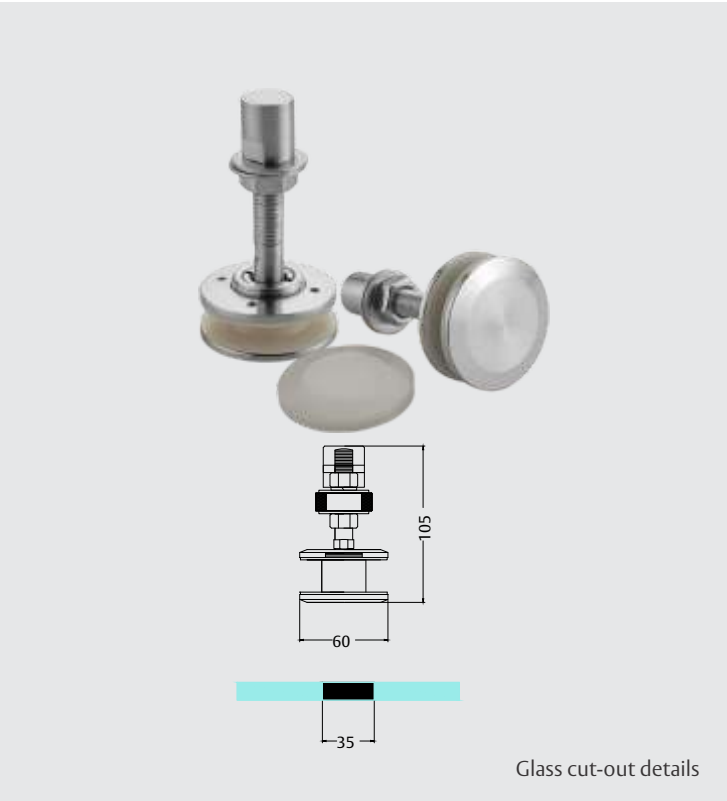

* 304 grade available as an option

EROUTEL 006

SS routel fixed flat head

- Features :
- Material : Stainless steel 316 grade

Article No.	Finish
EROUTEL 006	Satin/ Glossy

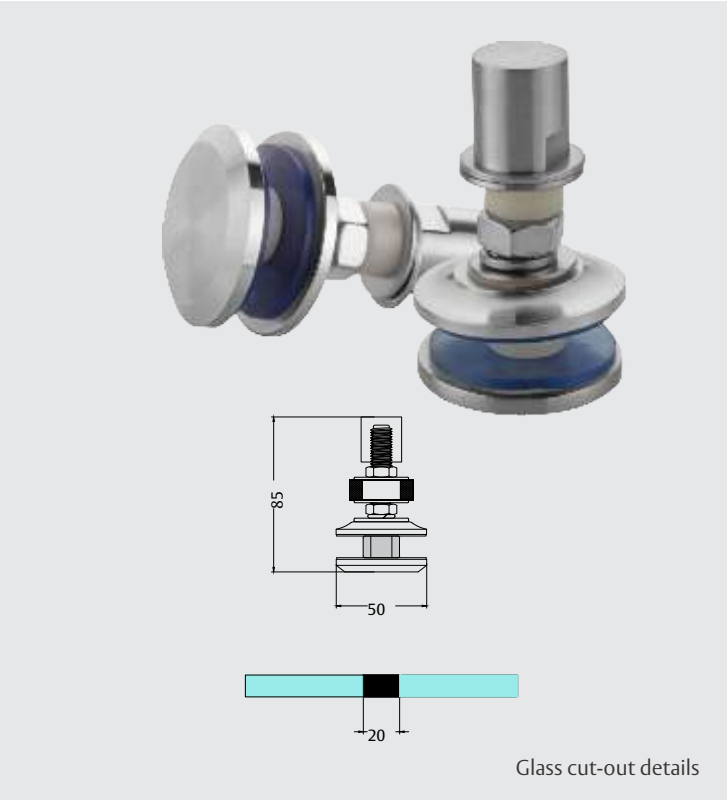

* 304 grade available as an option

Glass Spider Fitting

Fin & Splice plate

ESFP Fin Plate

Features :

- Material : Stainless steel 304 / 316 grade

Article No.	Length	Grade	Finish
ESFP 200	200mm	304	Satin/ Glossy
ESFP 200 A	200mm	316	Satin/ Glossy
ESFP 250	250 mm	304	Satin/ Glossy
ESFP 250 A	250mm	316	Satin/ Glossy
ESFP 350	350mm	316	Satin/ Glossy
ESFP 350 A	350 mm	304	Satin/ Glossy
ESFP 400	400mm	316	Satin/ Glossy
ESFP 400 A	400 mm	304	Satin/ Glossy



Glass cut-out details

ESSP Splice Plate

Features :

- Material : Stainless steel 304 / 316 grade

Article No.	Length	Grade	Finish
ESSP 200	200mm	304	Satin/ Glossy
ESSP 200 A	200mm	316	Satin/ Glossy
ESSP 250	250 mm	304	Satin/ Glossy
ESSP 250 A	250mm	316	Satin/ Glossy
ESSP 300	300mm	316	Satin/ Glossy
ESSP 300 A	300 mm	304	Satin/ Glossy
ESSP 400	400mm	316	Satin/ Glossy
ESSP 400 A	400 mm	304	Satin/ Glossy



Glass cut-out details

Legal Disclaimer

Whilst every effort has been made to ensure that the information contained in this brochure is accurate at the time of publication, ENOX recommends that you consult ENOX or its agents or its authorised dealer or its authorised distributor prior to placing an order to ascertain current information on specific product, as ENOX reserves the right to make changes without prior notice. ENOX will not be liable for any injury, loss or damage whatsoever, arising from any errors or omissions in the information contained in the brochure or arising from the use or application of the information contained herein. This brochure does not constitute an offer for the sale of any particular product.

ENOX E

ASSA ABLOY

MUMBAI

EcoStar, 11th Floor, 1101 / 1103,
Off Aarey Road, Vishweshwar Nagar
Goregoan (East), Mumbai - 400063,
Tel : +91-22-6180 5555
displaycentre@enox.in

PUNE

Sr. No.36, Hissa No.1, Plot No.11,
Village Pisoli Haveli Kondhwa,
Pune - 411 028, Maharashtra
Tel : +91-9702203659/63
displaycentre.pun@enox.in

SURAT

Plote No.11, 1St Floor, Shiv Ashish
Industrail Estate, Off Udhana/
Magadal Road, Nr.Hyundai Showrrrom,
Surat, Gujarat
Tel : +91-8511148472
displaycentre.sur@enox.in

BENGALURU

#36/2, Third & Fourth Floor,
Patalamma Temple Street,
Near South-end Circle, Basavanagudi,
Bengaluru-560 004, Karnataka
Tel : +91-7207217088/92
displaycentre.blr@enox.in

HYDERABAD

2nd Floor, Alcazar Mall, Plot No. 497/498,
Road No. 36, Jubilee Hills,
Hyderabad-500 033, Telangana
Tel : +91-7207217085
displaycentre.hyd@enox.in

CHENNAI

23-2, Old No 39-2, Cenotaph Road,
1st Lane, Near to Crown Plaza Hotel,
Opp Canara Bank, Teynampet,
Chennai-600 018
Tel : +91-9940360525 / 9840330292
displaycentre.che@enox.in